



6 November 2018 Revised: 20 March, 2019

Addendum 3

East Coast Hearing and Balance
Morehead City, North Carolina

The following addendum shall supersede previous information and does hereby become part of the contract documents.

- ~~• The Bid Date has been revised to 20 November 2018 at 4pm.~~
- ~~• Base bid to include a full fire sprinkler system designed and installed by a NC Fire Sprinkler company. Sprinkler system to include water curtain sprinklers at all windows on rear wall. See attached revised Utility Plan with added 6" Fire Line, 6" RPZ Hotbox and tapping sleeve and valve. Provide electrical circuit to hotbox.~~
- ~~• Provide a limited fire alarm system to monitor the fire protection sprinkler system only. Install a flow switch on the main riser and tamper switches on all valves including the RPZ. The RPZ will be located on site by the sprinkler contractor. All switches shall be monitored by the system. The fire alarm panel shall be fully capable of offsite monitoring by the proper authorities. Provide a smoke detector within 5 feet of the addressable fire alarm control panel. Provide a manual pull station in the sprinkler riser room and a weather proof horn strobe on the exterior of the building. All work shall meet NFPA 13 and current codes.~~
- ~~• Provide a \$7,500 material and labor allowance to install a 3-ton HVAC system on the second floor to maintain sprinkler system from freezing.~~
- Clarification: Please delete the requirement for impact glazing shown in Addendum 2. Glazing and framing to be as originally specified.
- Clarification: All exterior walls to be 2x6 @ 12" O.C.
- Drawing 1/S-1.1: Shelf angle at elevator shaft for truss bearing to be 4" x 4" x 3/8" bolted into CMU w/ 5/8" bolts @ 16" O.C. Fill cells of CMU solid at angle.
- Clarification: Drawing 1/S-1.1: Dropped beam at floor opening near elevator to be (2) 1 3/4" x 11 1/4" LVL as shown on 8/A-1.1.
- Clarification: Stair treads to be LVP w/ LVP nosing or rubber tread w/ rubber nosing.
- Clarification: 2nd Floor shell 202: GWB as shown on sections required at underside of roof trusses and rear wall (1 hour rated) as well as stair rated walls. Remaining walls are not required to have GWB at this time. SAT on Second Floor required at stairs only.
- Clarification: Fire Extinguisher and fire department lock box as shown on G-2 are part of the Base Bid.
- Clarification: Tele/Data System is an empty system. Phone/date system and cabling N.I.C.
- Clarification: Break Area 113 appliances are N.I.C.
- Clarification: TVs and TV cabling are N.I.C. Provide empty system for connection by others.

End of Addendum 3

Lee D. Dixon, Jr., AIA
Architect/Owner
252-241-1868

P.O. Box 363
Morehead City, NC 28557
Lee@coastalarchitecture.net

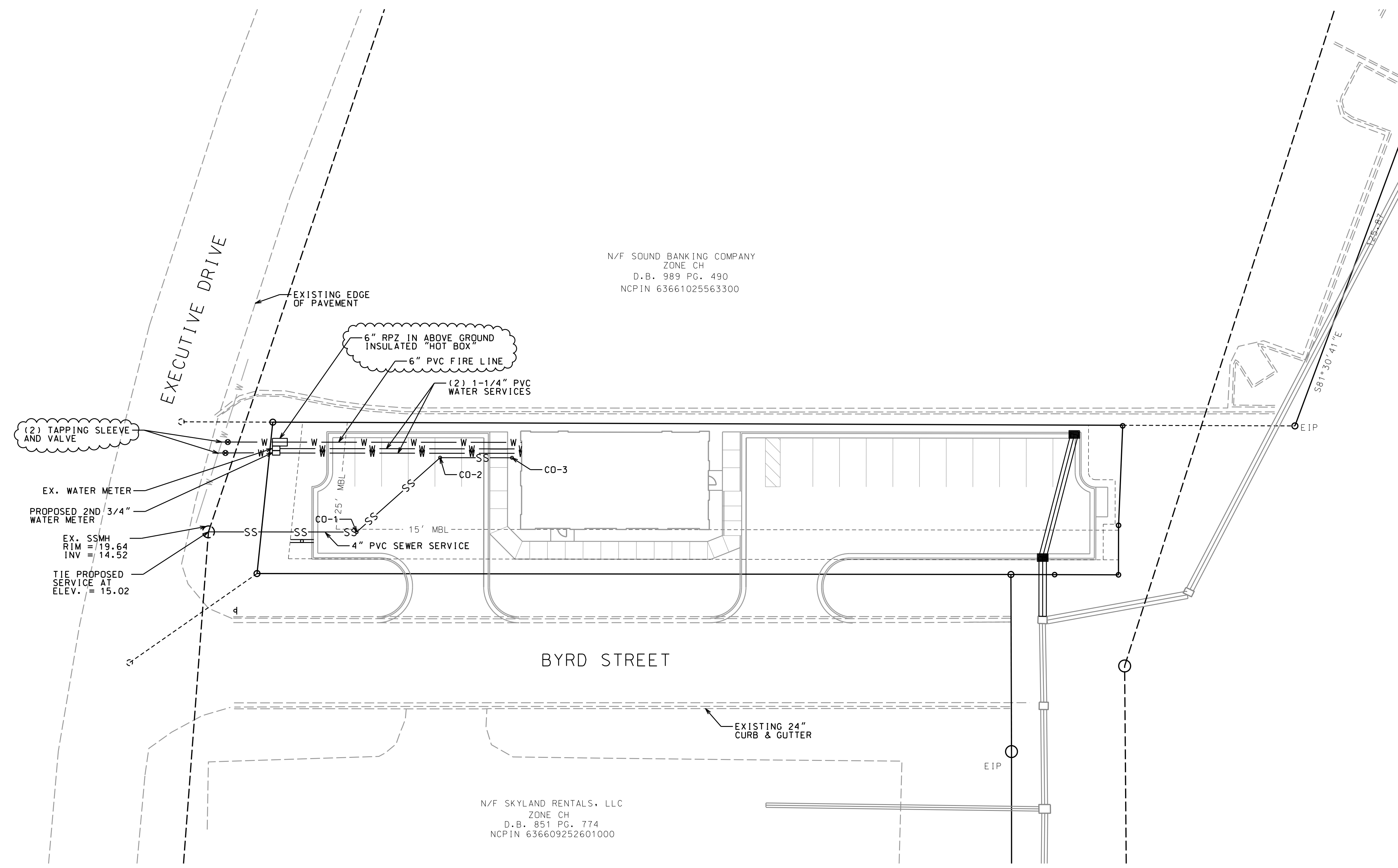

N/F SOUND BANKING COMPANY
 ZONE CH
 D.B. 989 PG. 490
 NCPIN 63661025563300

N/F SKYLAND RENTALS, LLC
 ZONE CH
 D.B. 851 PG. 774
 NCPIN 636609252601000

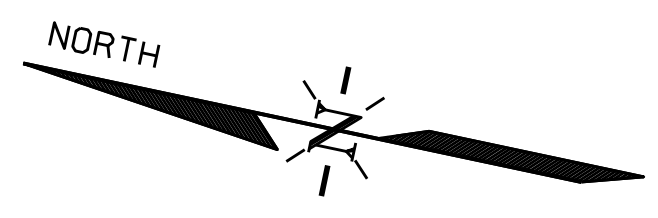

CLEAN OUT INFORMATION

CO-1 (TRAFFIC RATED)
RIM = 18.58
INV = 15.52
CO-2 (TRAFFIC RATED)
RIM = 18.60
INV = 15.90
CO-3
RIM = 19.20
INV = 16.15

- (2) TAPPING SLEEVE AND VALVE
- EX. WATER METER
- PROPOSED 2ND 3/4" WATER METER
- EX. SSMH RIM = 19.64 INV = 14.52
- TIE PROPOSED SERVICE AT ELEV. = 15.02

VOID

NOTE:
 TWO SEPARATE ELECTRIC METERS SHALL BE INSTALLED PER TOWN AND DUKE ENERGY REQUIREMENTS.

LEGEND

— W —	PROPOSED WATER SERVICE
— SS —	PROPOSED SEWER SERVICE
CO-#	PROPOSED CLEAN OUT

REVISIONS:

No.	BY	DATE	DESCRIPTION
1	CMC	11/5/18	ADD 6\"/>

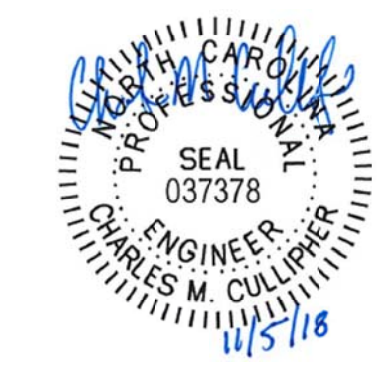
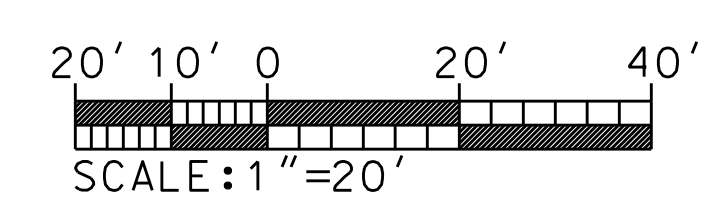

UTILITY PLAN

EAST COAST HEARING AND BALANCE, INC.
 5041 EXECUTIVE DRIVE
 MOREHEAD CITY TWSP., CARTERET COUNTY, NORTH CAROLINA

CLIENT: EAST COAST HEARING AND BALANCE, INC.	DESIGNED: CMC
ADDRESS: 5000 US HWY 70 MOREHEAD CITY, NC 28557	DRAWN: CMC
PHONE: 252-773-0636	CHECKED: RDC
THE CULLIPHER GROUP, P.A. ENGINEERING & SURVEYING SERVICES 151A HIGHWAY 24 MOREHEAD CITY, N.C. 28557 (252) 773-0090 LICENSE NO. C-4482	APPROVED: CMC
CHARLES M. CULLIPHER, P.E.	DATE: 8/14/18
	SCALE: 1"=20'