

COLUMBUS COUNTY SHERIFF'S OFFICE

104 COURTHOUSE ROAD

WHITEVILLE, NORTH CAROLINA

COLUMBUS COUNTY

DRAWINGS

COVER SHEET	C1 OF 8
EXISTING CONDITIONS AND DEMOLITION PLAN	C2 OF 8
SITE PLAN	C3 OF 8
UTILITY PLAN	C4 OF 8
GRADING PLAN	C5 OF 8
LANDSCAPE PLAN	C6 OF 8
IMPERVIOUS STRUCTURE BREAKDOWN PLAN	C7 OF 8
DETAILS	C8 OF 8

SYMBOLS & ABBREVIATIONS

(BG)	BELOW GRADE
BOL	BOLLARD
CLF	CHAIN-LINK FENCE
CO	CLEAN OUT
CTWR	COMMUNICATIONS TOWER
DI	DROP INLET
ECM	EXISTING CONCRETE MARKER
EIR	EXISTING IRON REBAR
FCE	FINISHED FLOOR ELEVATION
FOC	FIBEROPTIC CABLE
GS	GENERATOR SLAB
GW	GUYWIRE
ICV	IRRIGATION CONTROL VALVE
LA	LANDSCAPED AREA
NS	NAIL SET
OHE	OVERHEAD ELECTRIC
PA	PLAYGROUND AREA
PB	POWER BOX
PC	PARKING CHOCK
PVC	POLYVINYL CHLORIDE
RCP	REINFORCED CONCRETE PIPE
WFO	WATER SHUT OFF
SS	SANITARY SEWER
TP	TELEPHONE PEDESTAL
UF	UNDERGROUND FIBEROPTIC
UG	UNDERGROUND GAS
WL	WATER LINE
PP	POWER POLE
NL	NIGHT LIGHT



VICINITY MAP

SCALE: 1" = 200'

LINETYPES

6"	EX. CONTOUR
SS	EX. SEWER LINE
W	EX. WATERLINE

PROJECT DATA

NAME OF PROJECT:
500 PENNY LANE DEVELOPMENT
500 PENNY LANE
MOREHEAD CITY, NORTH CAROLINA

PREPARED BY:
ARENDELL ENGINEERS
1004 ARENDELL STREET
MOREHEAD CITY, NC 28557
PHONE: (252) 622-4338
EMAIL: JOHN@ARENDELLENGINEERS.COM

PROPERTY OWNER:
S.F. BALLOU CONSTRUCTION
3302 BRIDGES ST, SUITE 1
MOREHEAD CITY, NC 28557

SURVEYOR:
KR BAREFOOT SURVEYING
PO BOX 1751
NEWPORT, NC 28570
PHONE: (252) 342-6230

DATUMS:
VERTICAL: NAVD88
HORIZONTAL: NC STATE PLANE COORDINATE SYSTEM

- NOTES:
- BOUNDARY AND TOPOGRAPHIC SURVEY PROVIDED BY KR BAREFOOT SURVEYING, DATED OCTOBER 27 & 28, 2022.
 - PROPERTY LOCATED IN FLOOD ZONE X PER FIRM MAP NUMBER 3720637600J DATED JULY 16, 2003.
 - PROPERTY IS ZONED OFFICE & PROFESSIONAL BY THE TOWN OF MOREHEAD CITY.
 - NUMBER OF PARKING SPACES REQUIRED:
OFFICE & PROFESSIONAL 1 SPACE / 250 FT² OF GROSS FLOOR AREA
8,267 SF / 250 SF = 33 SPACES REQUIRED
NUMBER OF SPACES PROVIDED = 34

THIS DRAWING IS THE PROPERTY OF ARENDELL ENGINEERS AND IS NOT TO BE REPRODUCED OR USED FOR ANY PROJECT IN WHOLE OR IN PART WITHOUT EXPRESS WRITTEN PERMISSION.

PROJECT MANAGER:	JJW
DESIGNED:	JJW
DRAWN BY:	JST
CHECKED:	JJW
SCALE:	AS SHOWN
DATE:	01/27/2025



1004 Arendell Street
Morehead City, NC 28557
(252) 622-4338
Fax: (252) 622-4505

www.arendellengineers.com

North Carolina Certification No. C-1509

OWNER:

COLUMBUS COUNTY

PROJECT:

SHERIFF'S OFFICE
817 WASHINGTON STREET
WHITEVILLE, NORTH CAROLINA 28472

COLUMBUS COUNTY, NC

DRAWING:

COVER SHEET

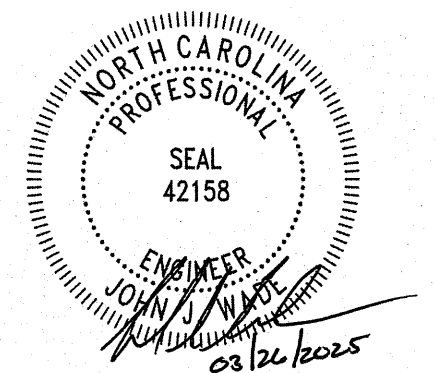

NO.	REVISION	DATE	BY
1	WATERLINE REVISIONS	01/29/25	JJW
2	PARKING AND DETAILS	03/26/25	JJW

SHEET NO:

C1

OF: 8
JOB NO. 24265



Know what's below.
Call before you dig.

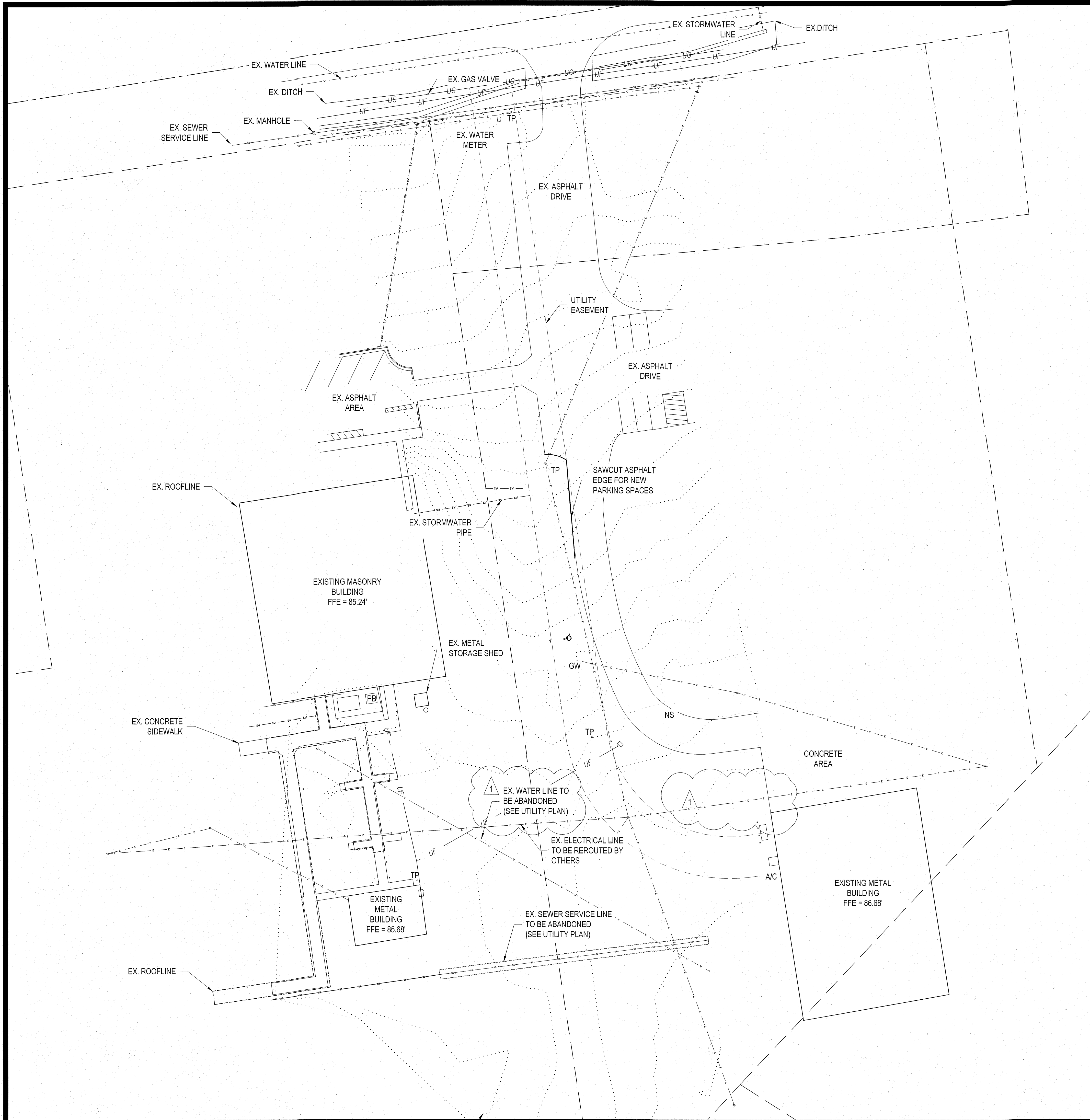

NOTES:

- BOUNDARY, TOPOGRAPHIC SURVEY PROVIDED BY SOLES & WALKER, P.A., P.L.S., DATED: 9/24/2024
- CONTRACTOR SHALL BE RESPONSIBLE FOR LOCATING ALL UTILITIES WITHIN PROJECT AREA PRIOR TO CONSTRUCTION AND PROTECTING UTILITIES AS NECESSARY.

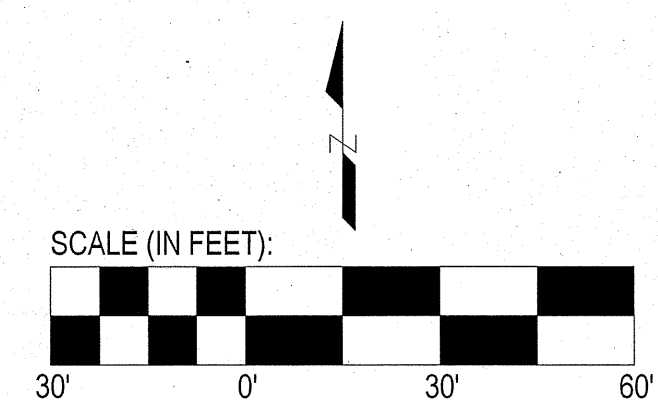

THIS DRAWING IS THE PROPERTY OF ARENDELL ENGINEERS AND IS NOT TO BE REPRODUCED OR USED FOR ANY PROJECT IN WHOLE OR IN PART WITHOUT EXPRESS WRITTEN PERMISSION.

PROJECT MANAGER: JJW
DESIGNED: JJW
DRAWN BY: JST
CHECKED: JJW
SCALE: 1" = 30'
DATE: 01/27/2025



1004 Arendell Street
Morehead City, NC 28557
(252) 622-4338
Fax: (252) 622-4505

www.arendellengineers.com

North Carolina Certification No. C-1509

OWNER:

COLUMBUS COUNTY

PROJECT:

SHERIFF'S OFFICE
817 WASHINGTON STREET
WHITEVILLE, NORTH CAROLINA 28472

COLUMBUS COUNTY, NC

DRAWING:

EXISTING CONDITIONS AND
DEMOLITION PLAN

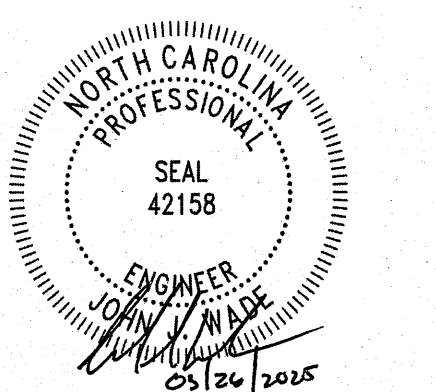

NO.	REVISION	BY	DATE
1	WATERLINE REVISIONS	JJW	01/29/25
2	PARKING AND DETAILS	JJW	03/26/25

SHEET NO:

C2

OF: 8

JOB NO. 24265

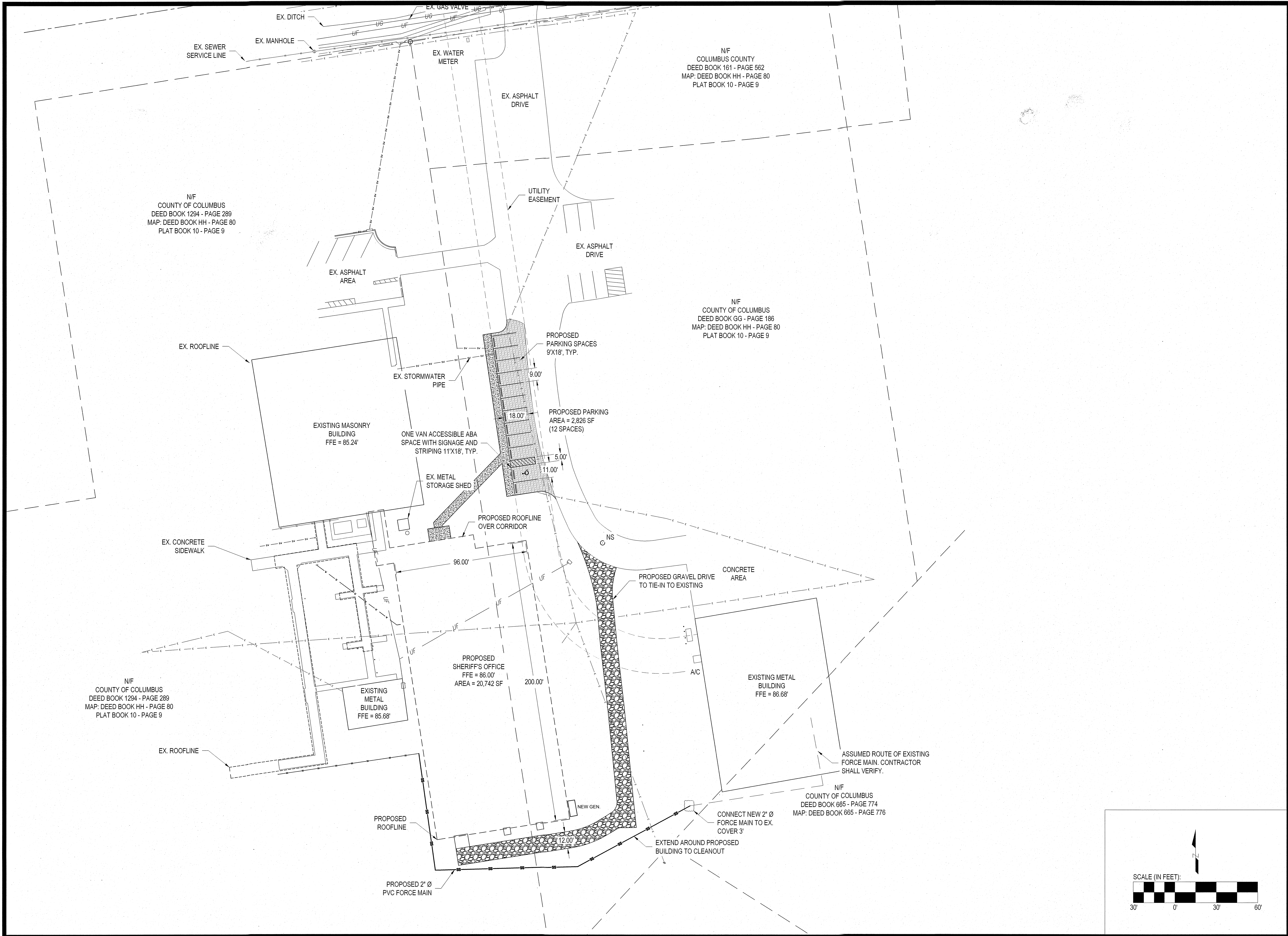

THIS DRAWING IS THE PROPERTY OF ARENDELL ENGINEERS AND IS NOT TO BE REPRODUCED OR USED FOR ANY PROJECT IN WHOLE OR IN PART WITHOUT EXPRESS WRITTEN PERMISSION.

PROJECT MANAGER: JJW
DESIGNED: JJW
DRAWN BY: JST
CHECKED: JJW
SCALE: 1" = 30'
DATE: 01/27/2025

ARENDELL ENGINEERS
CIVIL • COASTAL • ENVIRONMENTAL
1004 Arendell Street
Morehead City, NC 28557
(252) 622-4338
Fax: (252) 622-4505

www.arendellengineers.com
North Carolina Certification No. C-1509
OWNER:

COLUMBUS COUNTY

PROJECT:
SHERIFF'S OFFICE
817 WASHINGTON STREET
WHITEVILLE, NORTH CAROLINA 28472

COLUMBUS COUNTY, NC

DRAWING:
SITE PLAN

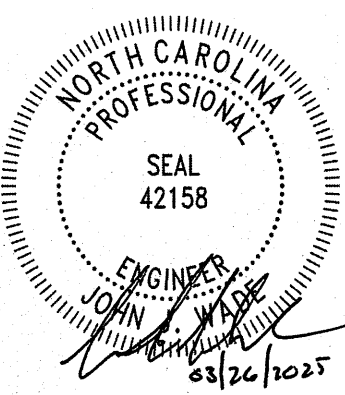

DATE	01/29/25	03/26/25			
BY	JJW	JJW			
REVISION	WATERLINE REVISIONS	PARKING AND DETAILS			
NO.	1	2			

SHEET NO:
C3
OF: 8
JOB NO. 24265

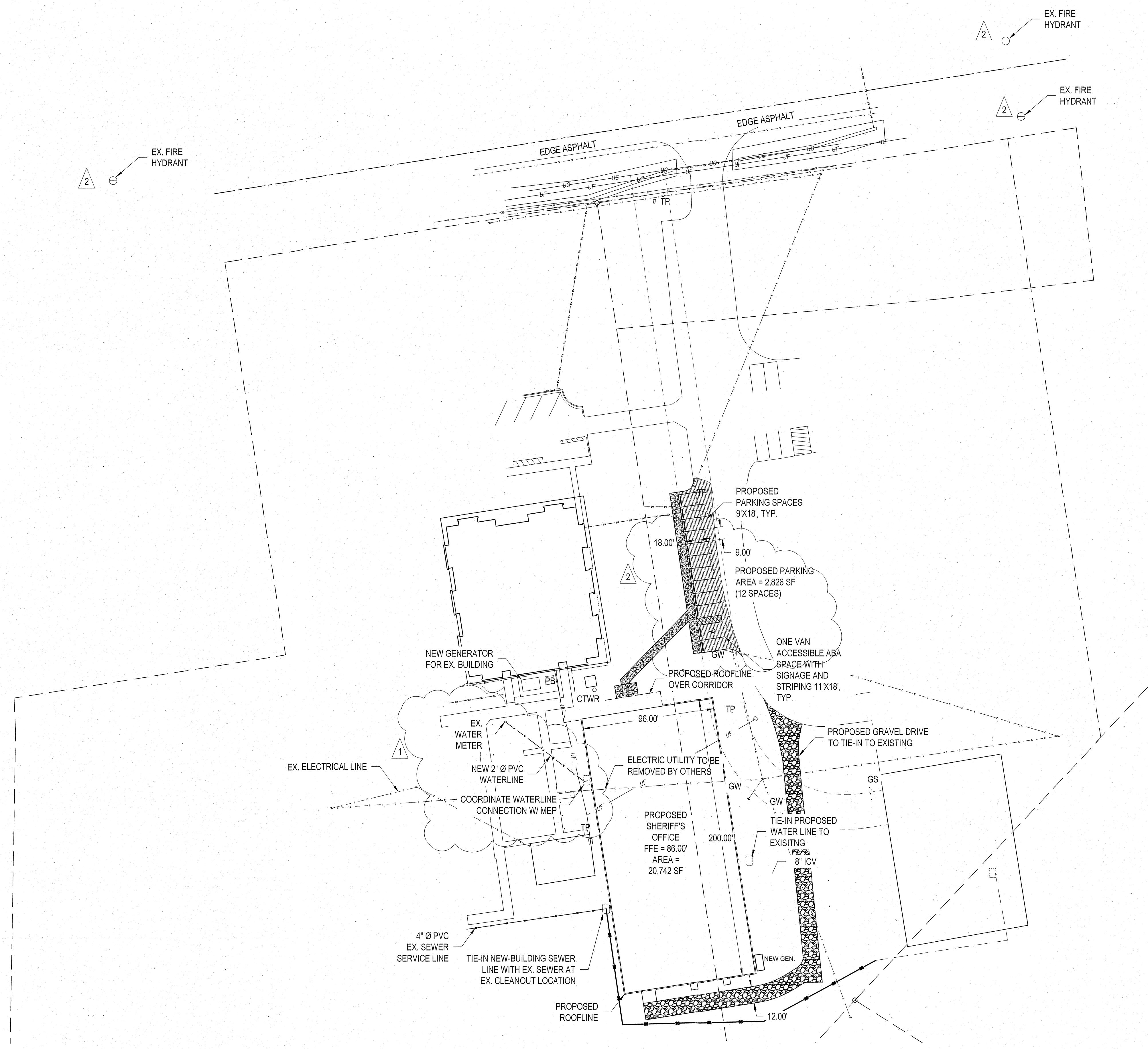

NOTES:
WATER AND SEWER SERVICES TO BE COORDINATED
WITH MEP ARCHITECTS AND EXISTING SITE UTILITIES.

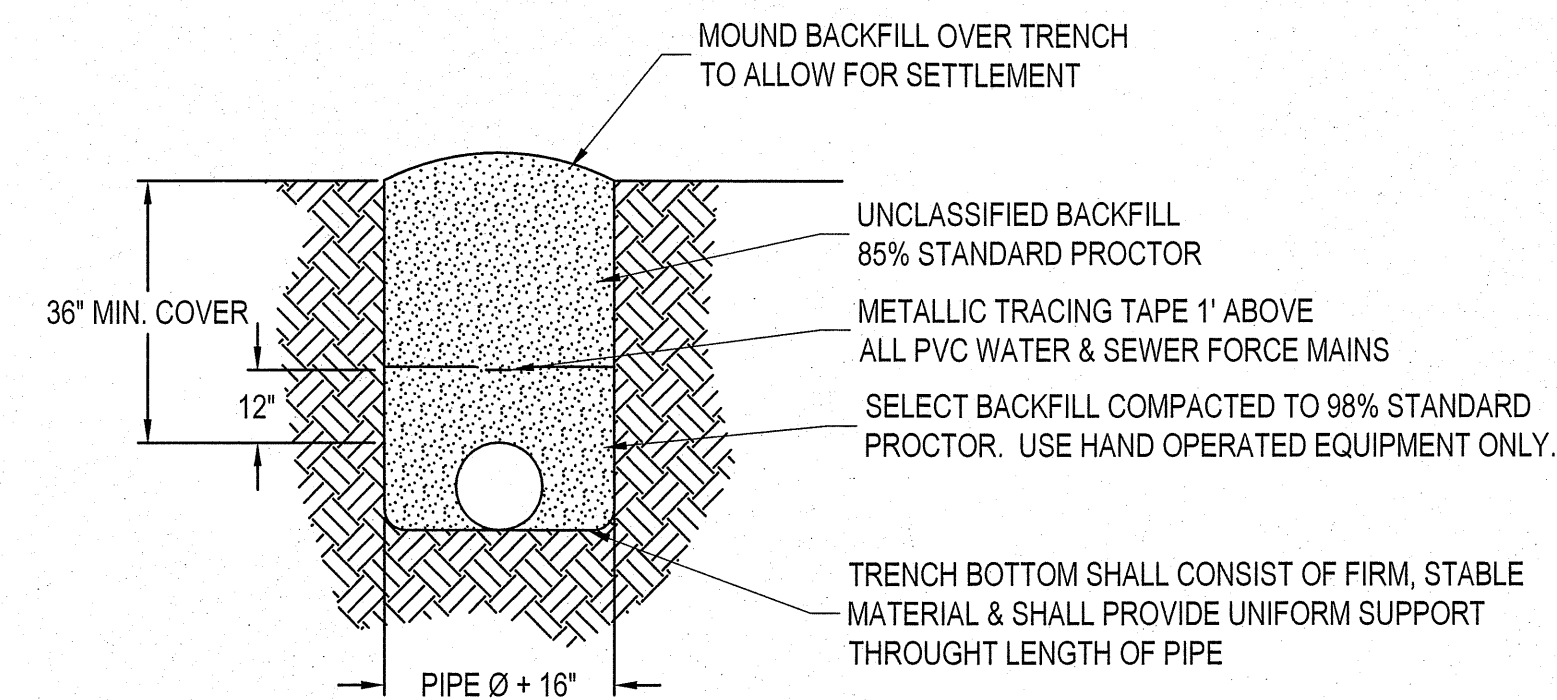
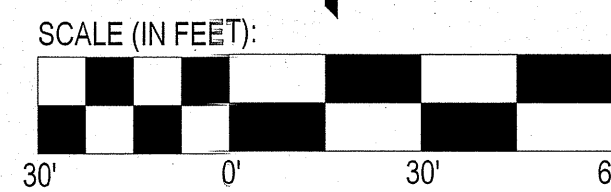

NOTE: FOR MULTIPLE PIPES, PROVIDE 18" MINIMUM SEPARATION.

PIPE TRENCH OUTSIDE PAVED AREA

SCALE: NOT TO SCALE

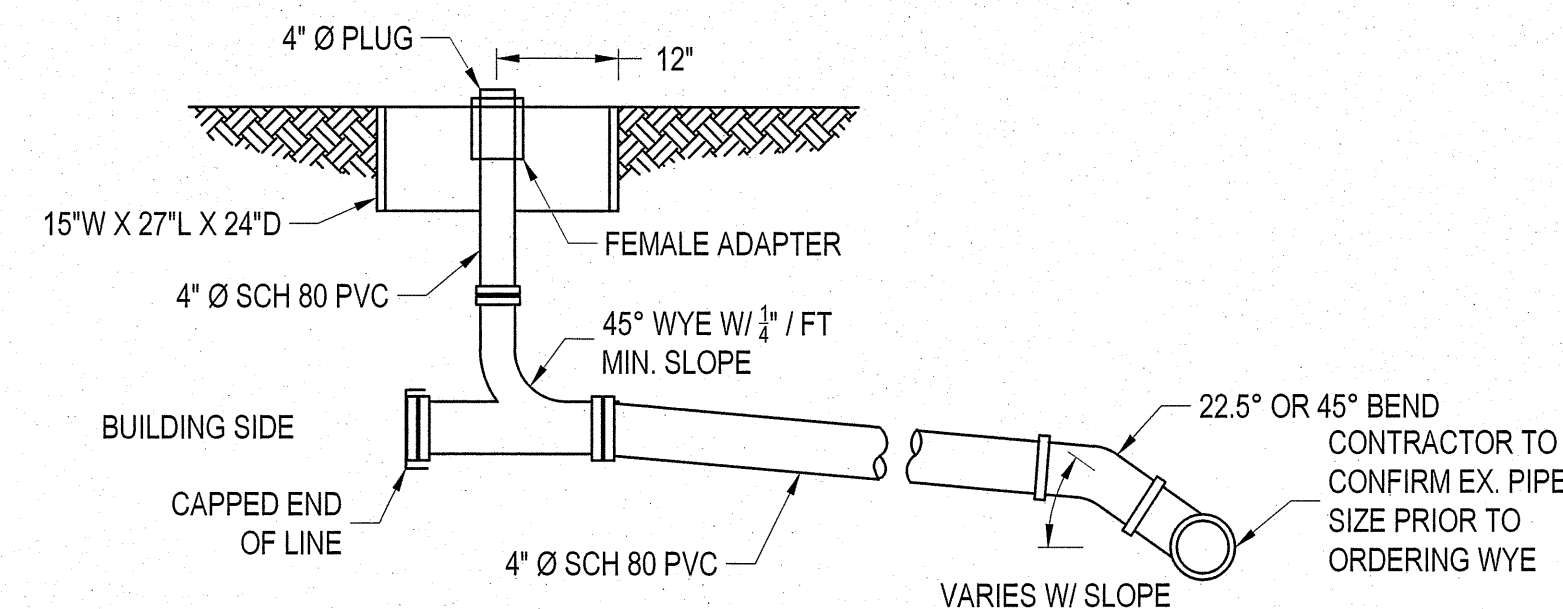

SANITARY SEWER CLEANOUT

SCALE: NOT TO SCALE

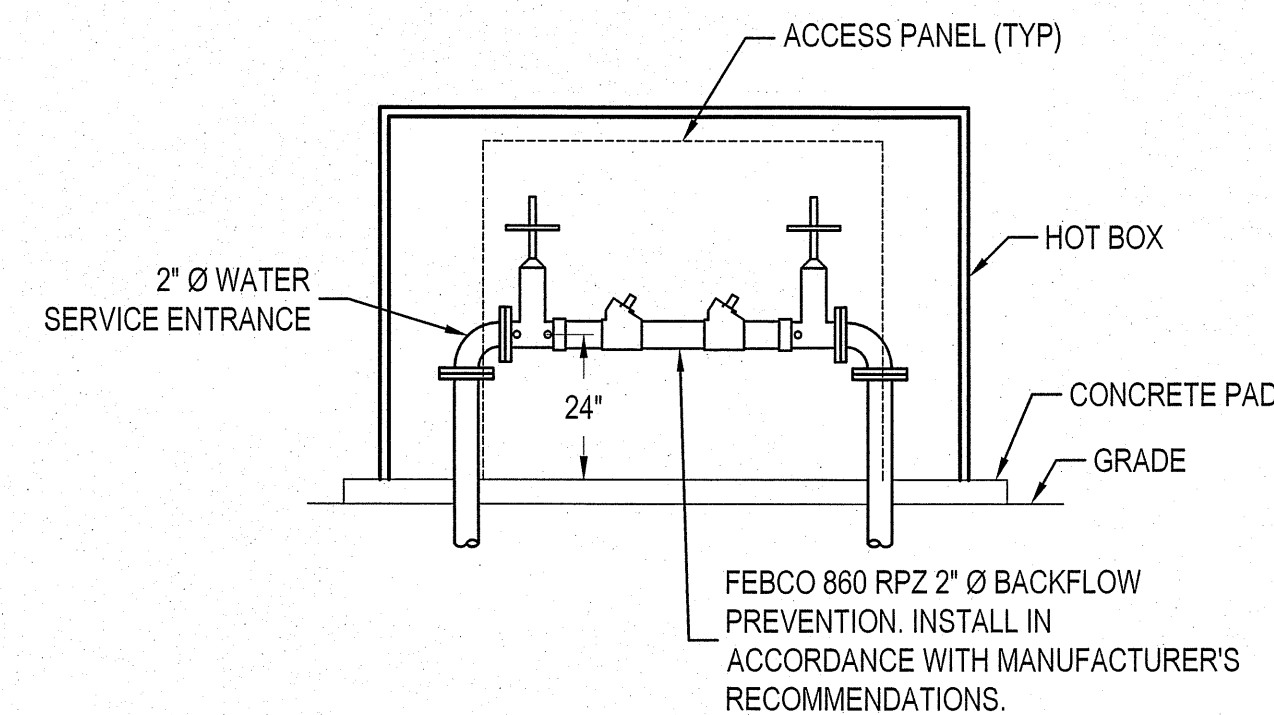

ELEVATION

NOTE: CONTRACTOR SHALL PROVIDE HEATED ALUMINUM HOT BOX WITH MINIMUM INTERIOR DIMENSIONS OF 15" WIDE X 40" LONG X 42" TALL.

WATER SERVICE RPZ DETAIL

SCALE: NOT TO SCALE

THIS DRAWING IS THE PROPERTY OF ARENDELL ENGINEERS AND IS NOT TO BE REPRODUCED OR USED FOR ANY PROJECT IN WHOLE OR IN PART WITHOUT EXPRESS WRITTEN PERMISSION.

PROJECT MANAGER:

JJW

DESIGNED:

JJW

DRAWN BY:

JST

CHECKED:

JJW

SCALE:

1" = 30'

DATE:

01/27/2025

ARENDELL ENGINEERS
CIVIL • COASTAL • ENVIRONMENTAL

1004 Arendell Street
Morehead City, NC 28557
(252) 622-4338
Fax: (252) 622-4505

www.arendellengineers.com

North Carolina Certification No. C-1509

OWNER:

COLUMBUS COUNTY

PROJECT:

SHERIFF'S OFFICE
817 WASHINGTON STREET
WHITEVILLE, NORTH CAROLINA 28472

COLUMBUS COUNTY, NC

DRAWING:

UTILITY PLAN

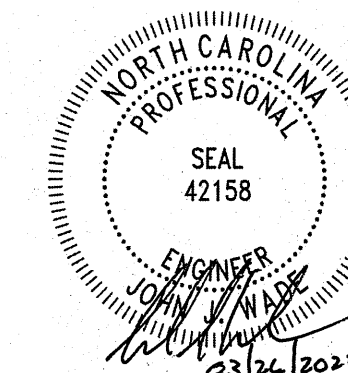

NO.	REVISION	BY	DATE
1	WATERLINE REVISIONS	JJW	01/29/25
2	PARKING AND DETAILS	JJW	03/26/25

SHEET NO:

C4

OF: 8

JOB NO.

24265

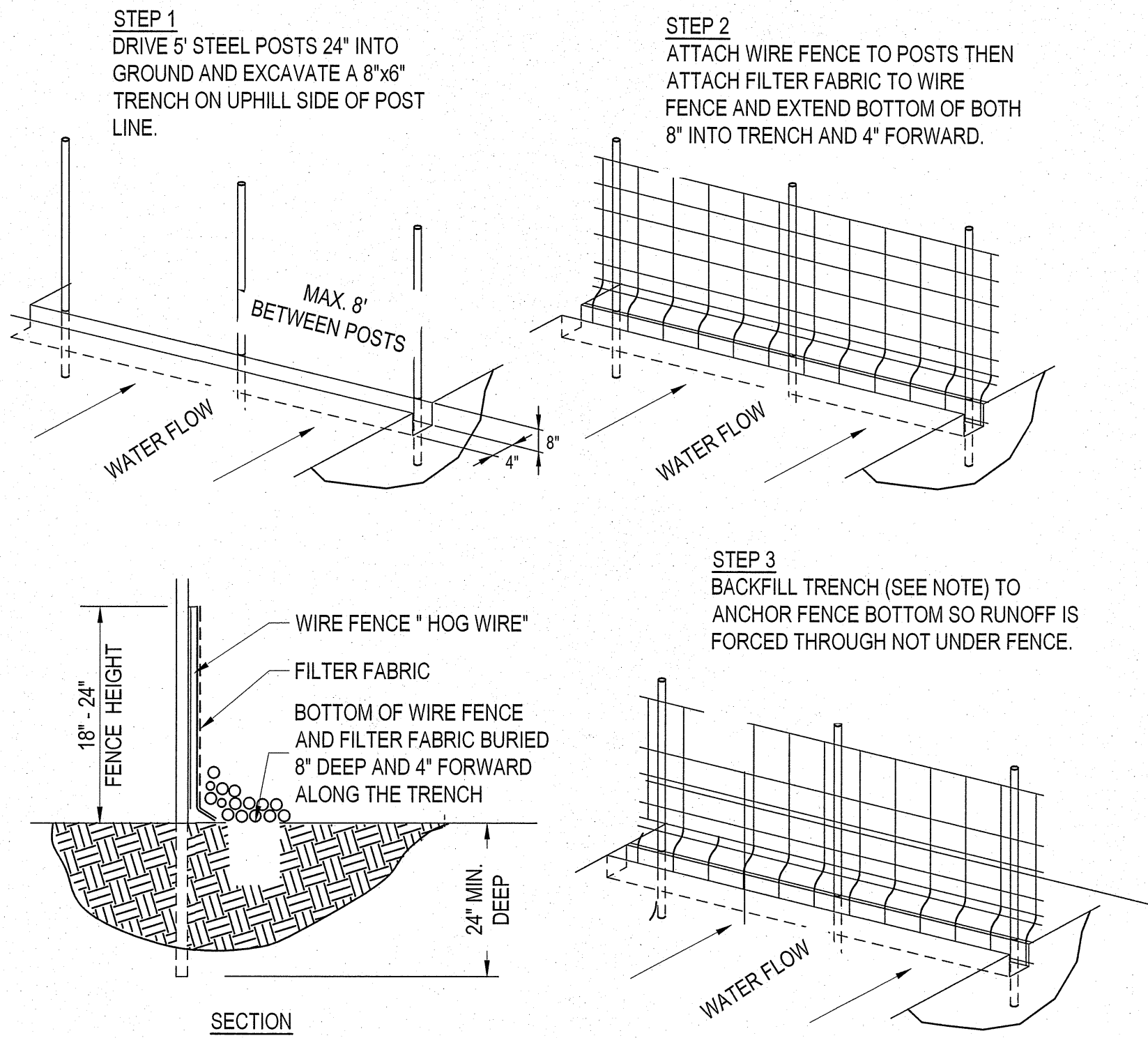
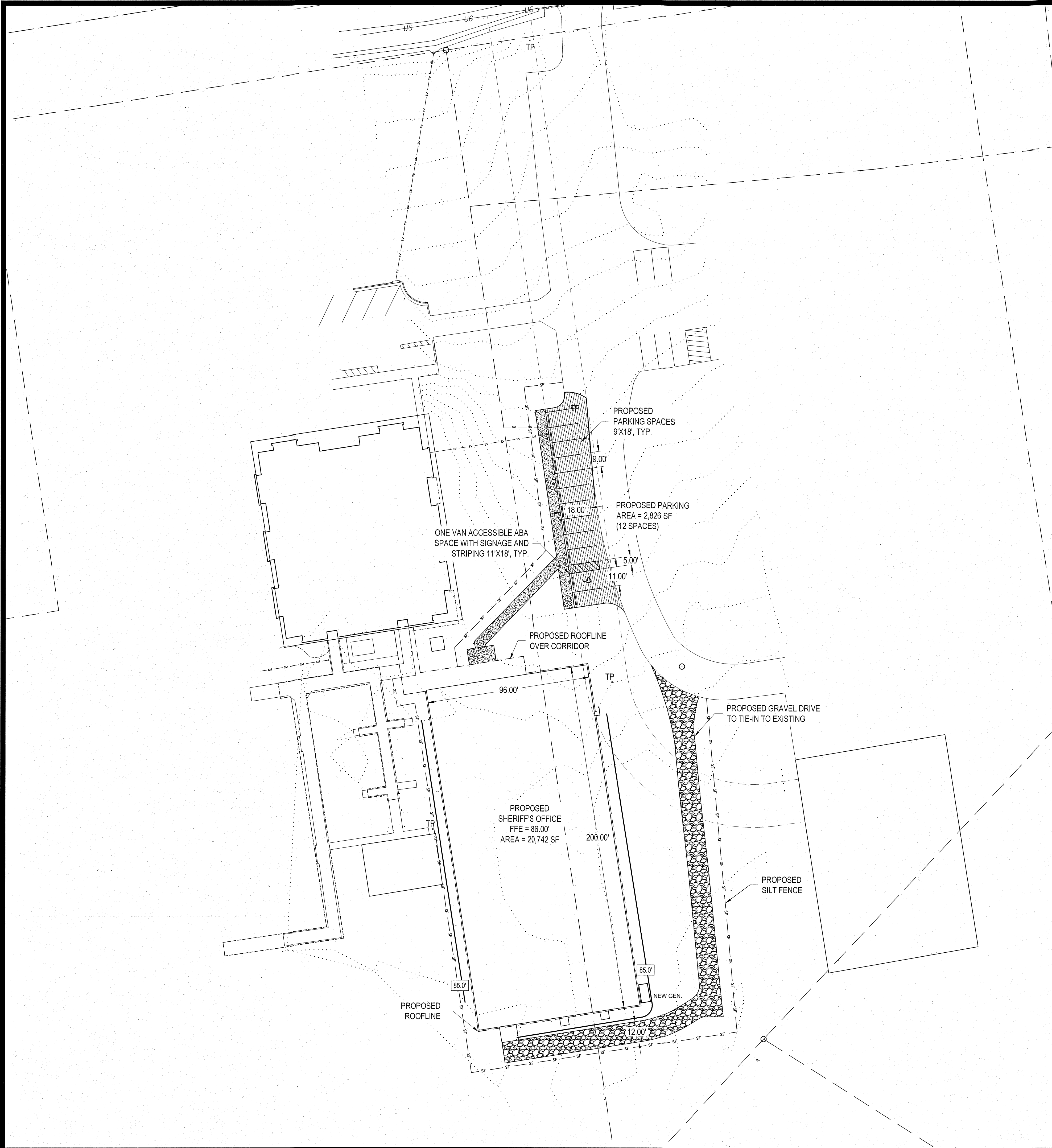

TEMPORARY SILT FENCE

SCALE: NOT TO SCALE

- NOTES:
- SEE EROSION CONTROL GENERAL NOTES.
 - FILTER FABRIC BOTTOM SHALL BE PLACED 8" IN TRENCH AND 4" FORWARD AND SECURED BY EITHER WASHED STONE EXTENDING A MINIMUM OF 6" ABOVE GROUND LEVEL OR TAMPED SOIL BACKFILL MATERIAL TO GROUND LEVEL OR HIGHER.

- NOTES:
- APPROX. 8,200 SF OF DISTURBED AREA OUTSIDE OF THE PROPOSED SHERIFF'S OFFICE.
 - APPROX. DISTURBED AREAS WILL BE SODDED.

LEGEND:

XX.X' PROPOSED COUNTOUR ELEVATION

XX.X' EXISTING COUNTOUR AND ELEVATION

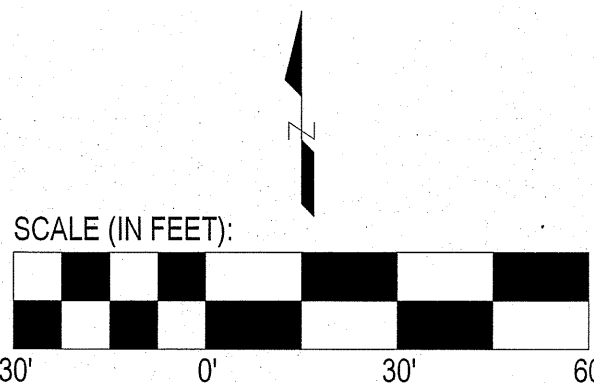

THIS DRAWING IS THE PROPERTY OF ARENDELL ENGINEERS AND IS NOT TO BE REPRODUCED OR USED FOR ANY PROJECT IN WHOLE OR IN PART WITHOUT EXPRESS WRITTEN PERMISSION.

PROJECT MANAGER: JJW

DESIGNED: JJW

DRAWN BY: JST

CHECKED: JJW

SCALE: 1" = 30'

DATE: 01/27/2025

ARENDELL ENGINEERS
CIVIL - COASTAL - ENVIRONMENTAL

1004 Arendell Street
Morehead City, NC 28557
(252) 622-4338
Fax: (252) 622-4505

www.arendellengineers.com
North Carolina Certification No. C-1509

OWNER: COLUMBUS COUNTY

PROJECT: SHERIFF'S OFFICE
817 WASHINGTON STREET
WHITEVILLE, NORTH CAROLINA 28472

COLUMBUS COUNTY, NC

DRAWING: GRADING PLAN

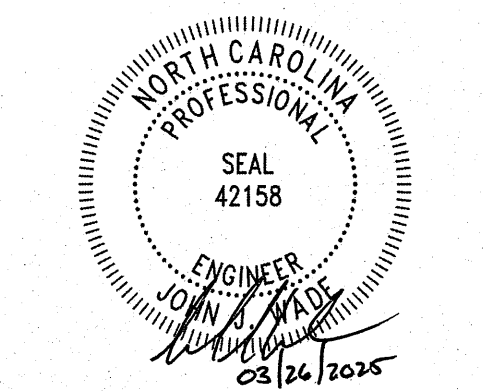

DATE	01/29/25	03/26/25			
BY	JJW	JJW			
REVISION	WATERLINE REVISIONS	PARKING AND DETAILS			
NO.	1	2			

SHEET NO: C5

OF: 8

JOB NO. 24265

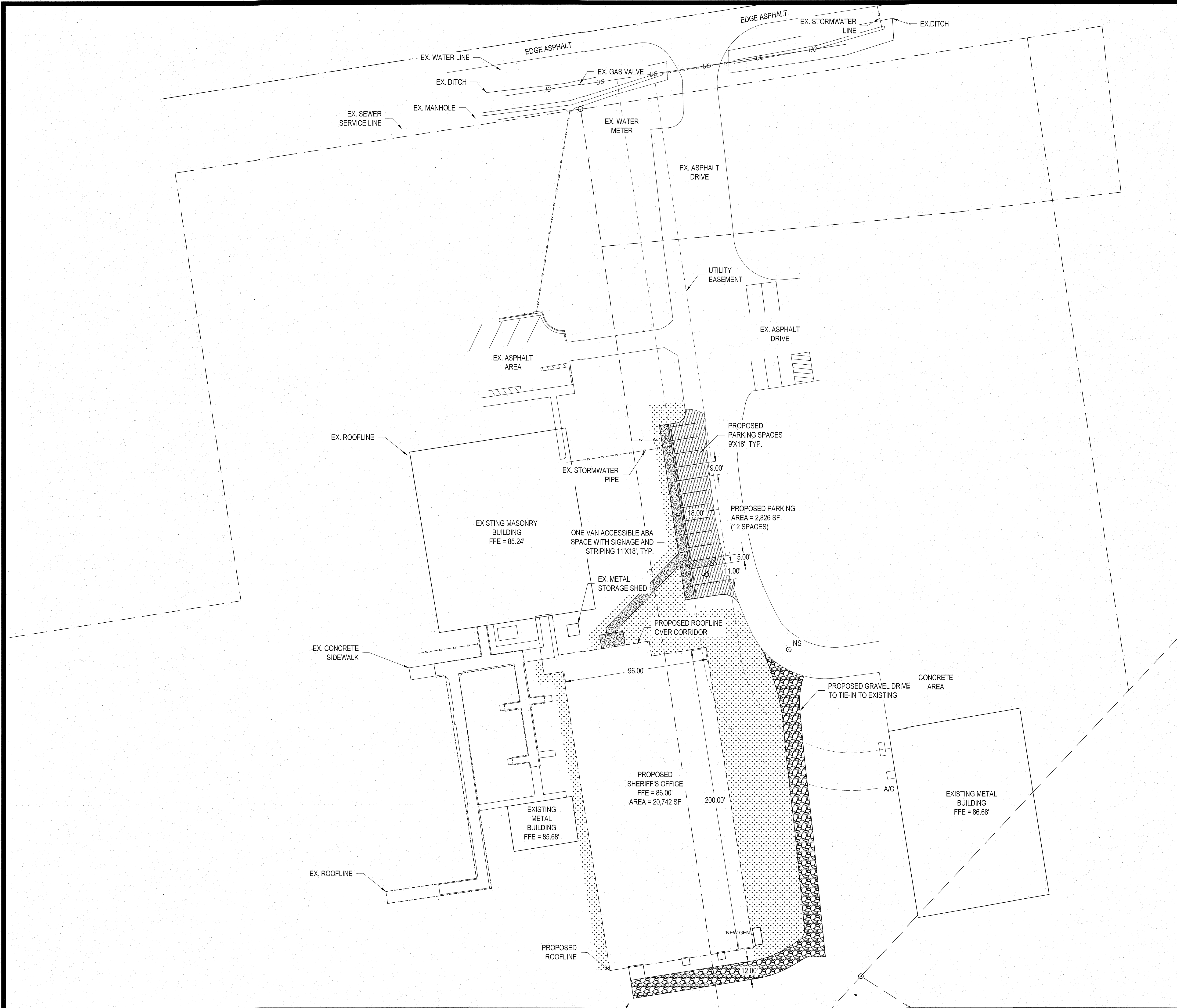

- NOTES:
- APPROX. 8,200 SF OF DISTURBED AREA OUTSIDE OF THE PROPOSED SHERIFF'S OFFICE.
 - APPROX. DISTURBED AREAS WILL BE SODDED.

 - DISTURBED AREAS TO BE SODDED

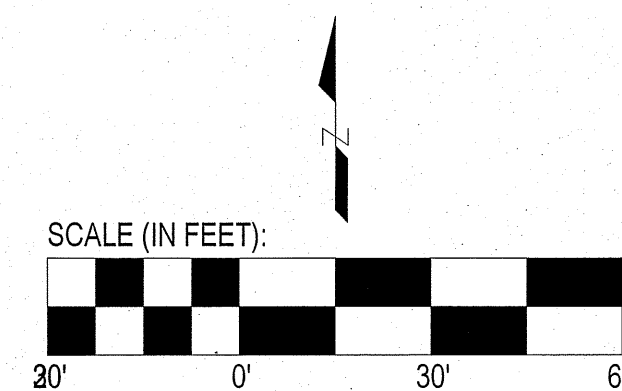

THIS DRAWING IS THE PROPERTY OF ARENDELL ENGINEERS AND IS NOT TO BE REPRODUCED OR USED FOR ANY PROJECT IN WHOLE OR IN PART WITHOUT EXPRESS WRITTEN PERMISSION.

PROJECT MANAGER: JJW

DESIGNED: JJW

DRAWN BY: JST

CHECKED: JJW

SCALE: 1" = 30'

DATE: 01/27/2025



1004 Arendell Street
Morehead City, NC 28557
(252) 622-4338
Fax: (252) 622-4505

www.arendellengineers.com

North Carolina Certification No. C-1509

OWNER:

COLUMBUS COUNTY

PROJECT:

SHERIFF'S OFFICE
817 WASHINGTON STREET
WHITEVILLE, NORTH CAROLINA 28472

COLUMBUS COUNTY, NC

DRAWING:

LANDSCAPE PLAN

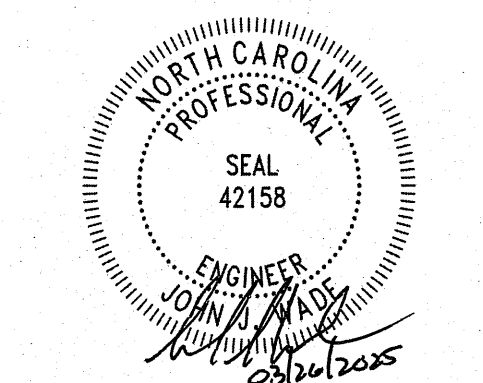

NO.	DATE	BY	REVISION
1	01/29/25	JJW	WATERLINE REVISIONS
2	03/26/25	JJW	PARKING AND DETAILS

SHEET NO:

C6

OF: 8

JOB NO.

24265

PROJECT MANAGER:	JJW
DESIGNED:	JJW
DRAWN BY:	JST
CHECKED:	JJW
SCALE:	1" = 30'
DATE:	01/27/2025

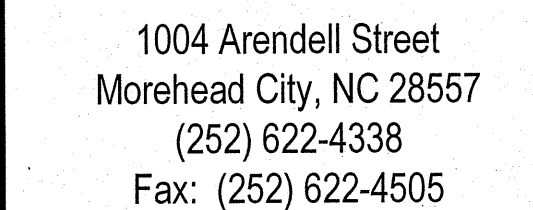

North Carolina Certification No. C-1509

COLUMBUS COUNTY

SHERIFF'S OFFICE
817 WASHINGTON STREET
WHITEVILLE, NORTH CAROLINA 28472

DRAWING:

Removed Building #1	1011
Removed Building #2	860
Removed Building #3	988
Removed Building #4	1059
Removed Building #5	982
Removed Building #6	941
Removed Building #7	1080
Removed Building #8	15702

Existing Building #1	12883
Existing Building #2	1318
Existing Sidewalk and Covering	3198
Existing Building #3	11203
Proposed Building and Covering	20742
Proposed Sidewalk	1304
Proposed Parking Area	3090

Existing Building #1	12883
Existing Building #2	1318
Existing Sidewalk and Covering	3198
Existing Building #3	11203
Removed Buildings	22623

2513

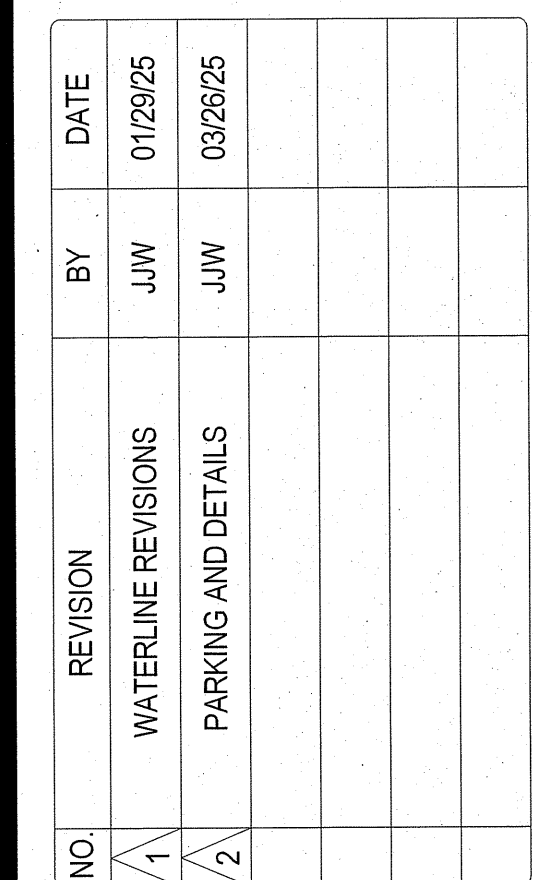

C7

JOB NO.

24265

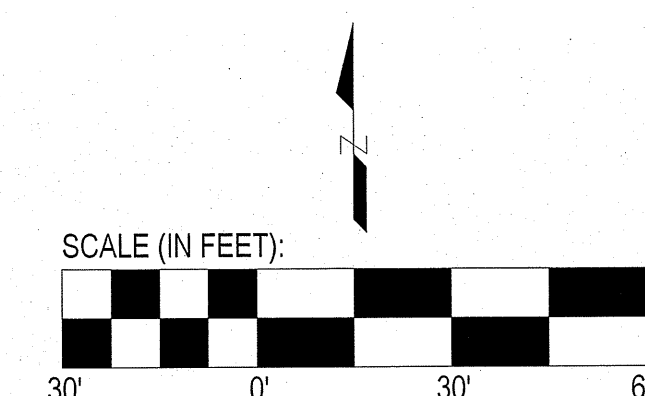

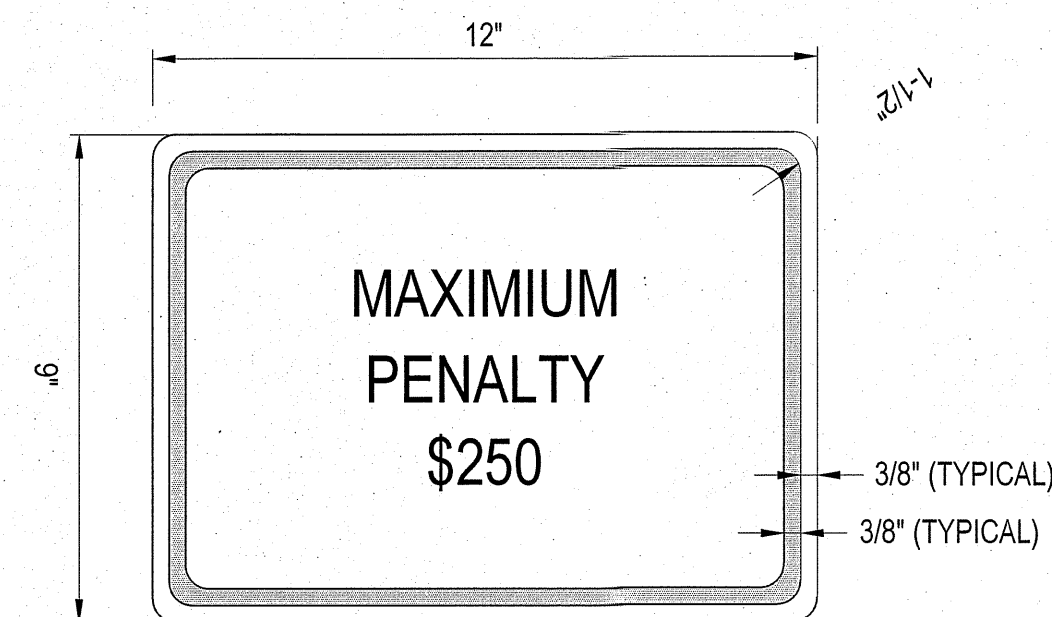

LEGEND AND BORDER - GREEN
BACKGROUND - WHITE
SIGNAGE TO CONFORM TO LOCAL CODES

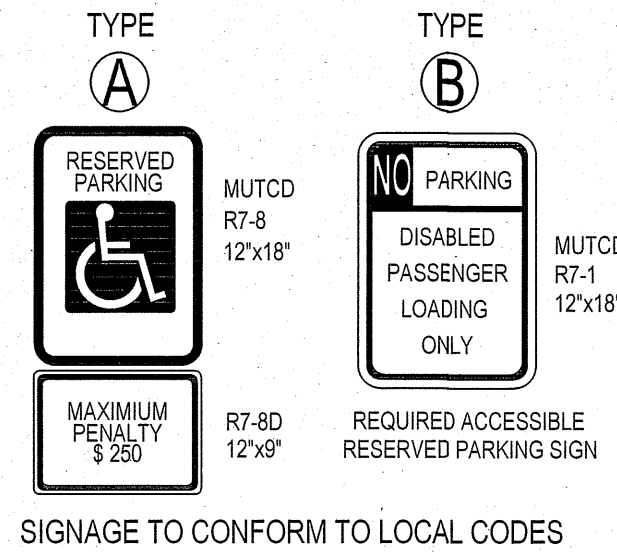

NOTES:
1. ALL 12"x18" ACCESSIBLE SIGNS (R7-8 & R7-1) 1. SHALL BE MOUNTED AT 7 FEET FROM GRADE TO BOTTOM EDGE OF SIGN FACE (MUTCD). MOUNTING HEIGHT CAN BE REDUCED TO 5 FEET IF PLACED IN AN AREA BETWEEN SIDEWALK AND BUILDING FACE IN WHICH PEDESTRIANS ARE NOT EXPECTED TO USE.
2. REFER TO MANUAL ON UNIFORM TRAFFIC CONTROL DEVICES, (MUTCD) AND U.S. DEPARTMENT OF TRANSPORTATION
3. IF ACCESSIBLE ROUTE IS A RAISED SIDEWALK AREA, THEN RAMPS ARE REQUIRED AT LOADING ZONE AREA.

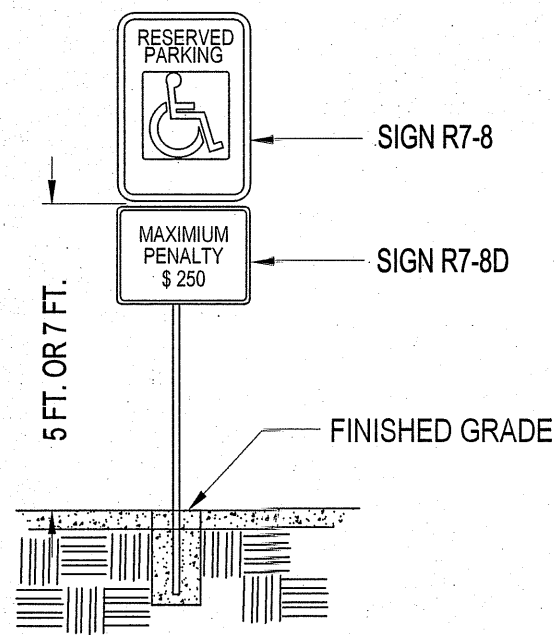

H.C. ACCESSIBLE SIGNAGE DETAILS
SCALE: NOT TO SCALE

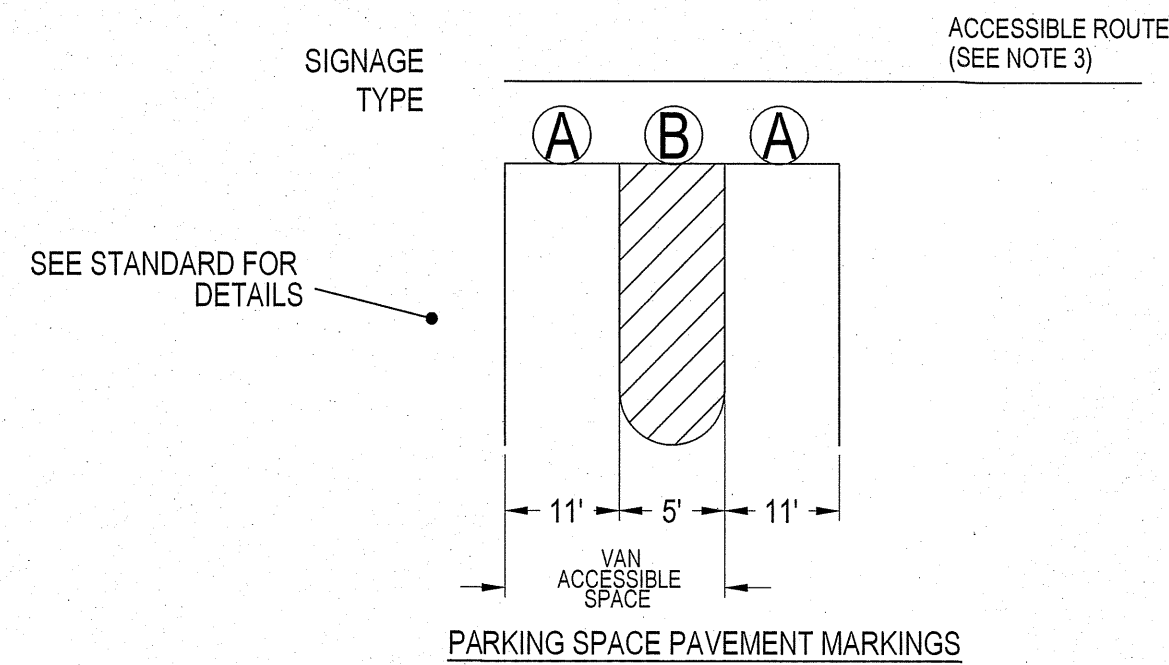

HANDICAP SIGNAGE DETAILS
SCALE: NOT TO SCALE

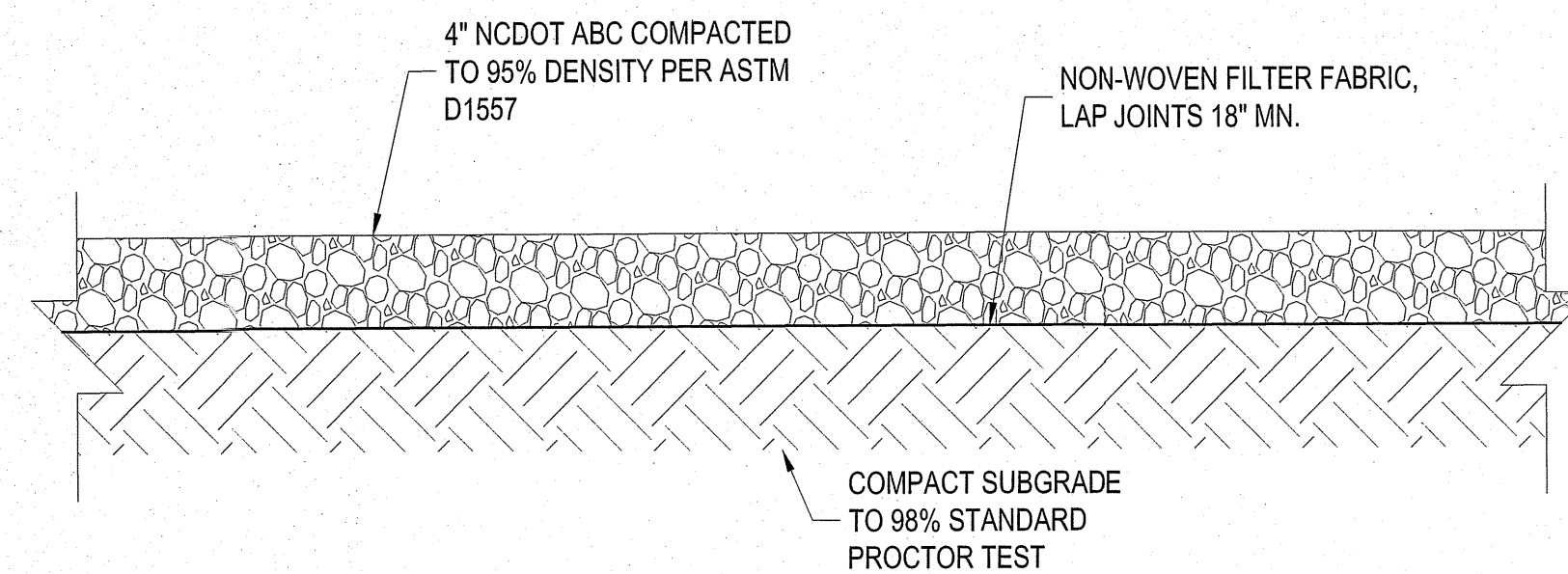

GRAVEL DRIVEWAY SECTION
SCALE: NOT TO SCALE

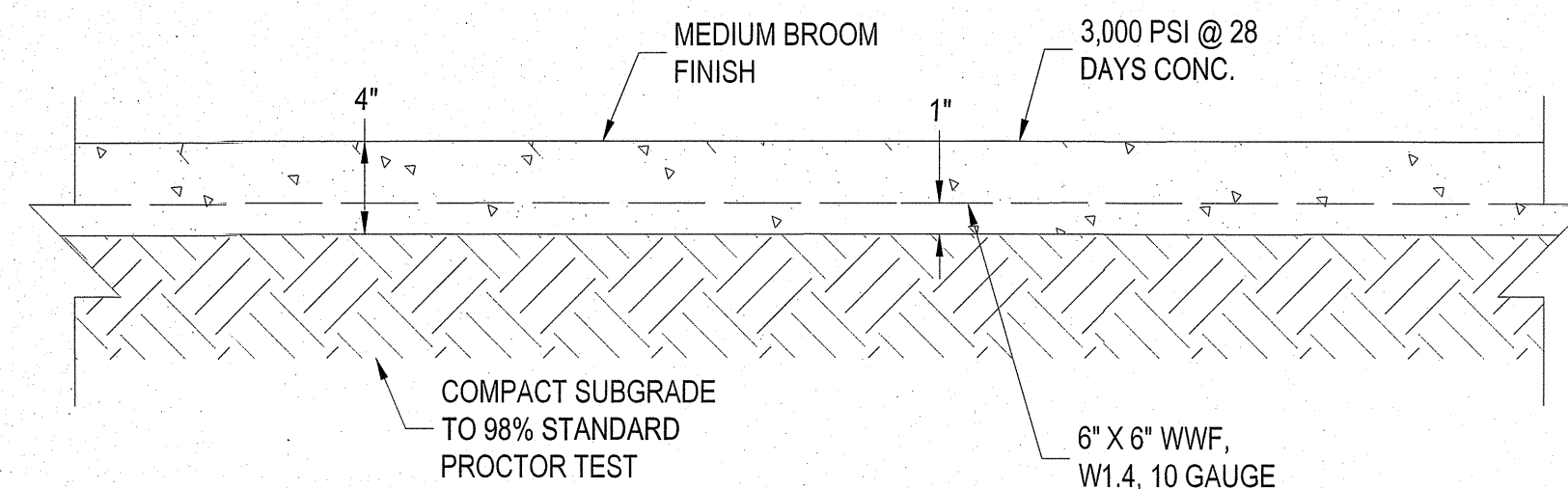

NOTE: CONSTRUCTION JOINTS SHALL BE LOCATED AT 12' O.C. MAX AND EXPANSION JOINTS AT 40' O.C. MAX.

CONCRETE SIDEWALK SECTION
SCALE: NOT TO SCALE

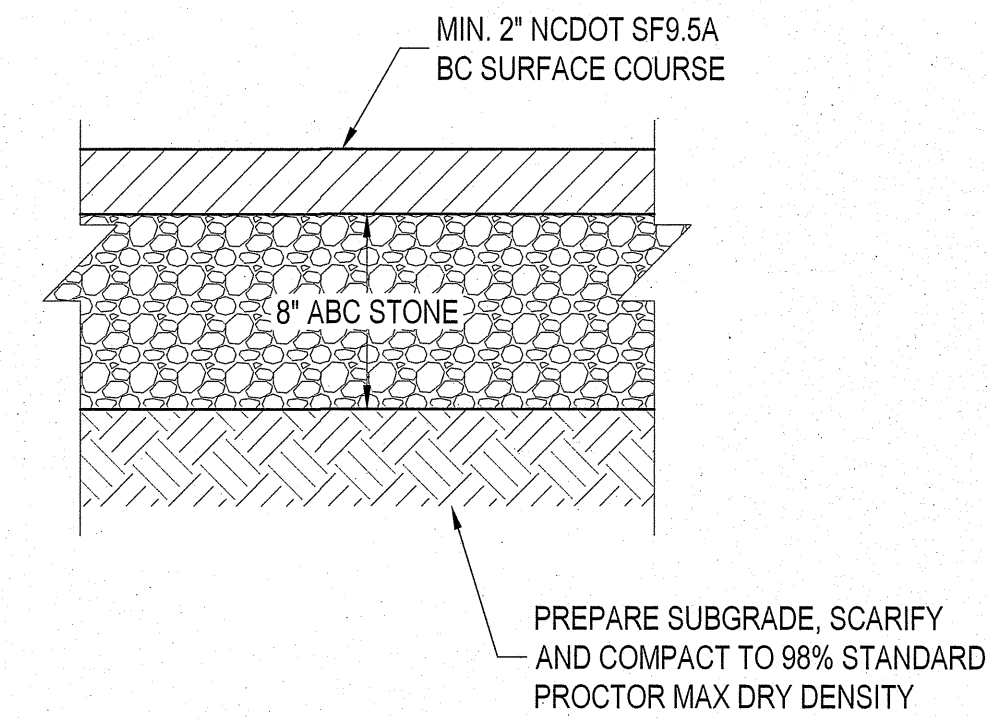

NOTES:
1. PROVIDE AGGREGATE BASE COURSE IN ACCORDANCE WITH NCDOT SPECIFICATIONS, SECTION 520. COMPACT TO 100% DENSITY IN ACCORDANCE WITH AASHTO T-99.
2. PROOF ROLLING MAY BE USED IN LIEU OF DENSITY TESTING USE 50 TON DUMP TRUCK OR HEAVY ROLLER. PROOF ROLL IN PRESENCE OF THE ENGINEER. AREAS TOO SMALL TO ALLOW PROOF ROLLING SHALL BE TESTED AS REQUIRED IN PRESENCE OF ENGINEER.

ASPHALT PAVEMENT - PARKING BAYS
SCALE: NOT TO SCALE

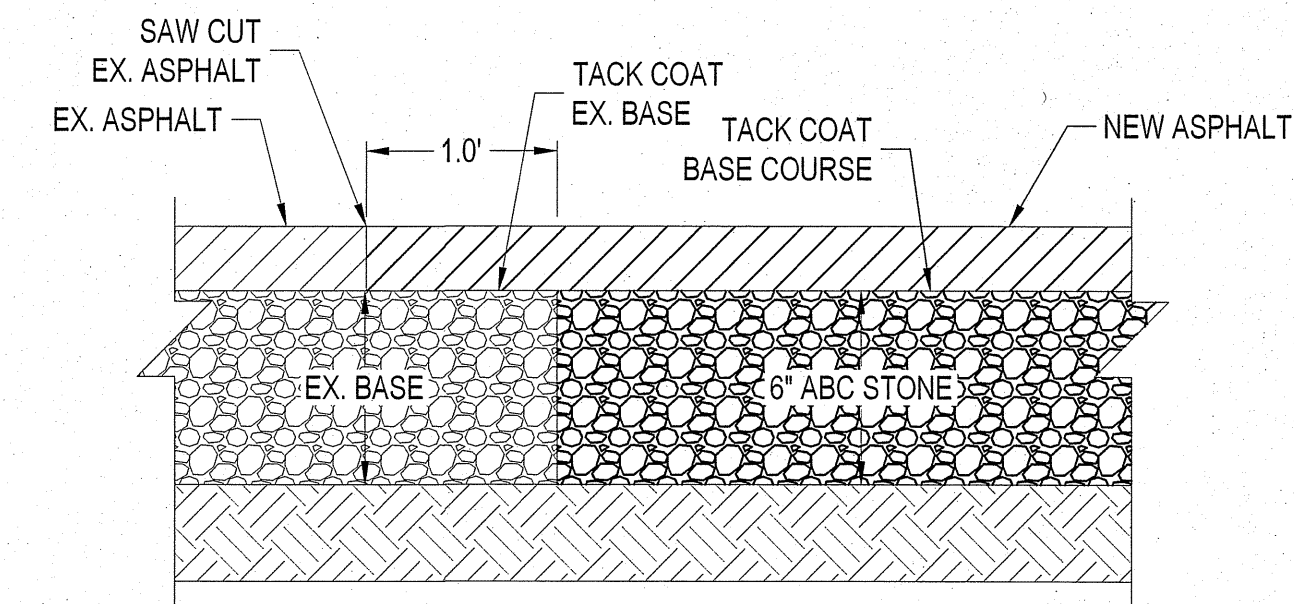

ASPHALT SAW CUT, TYPICAL
SCALE: NOT TO SCALE

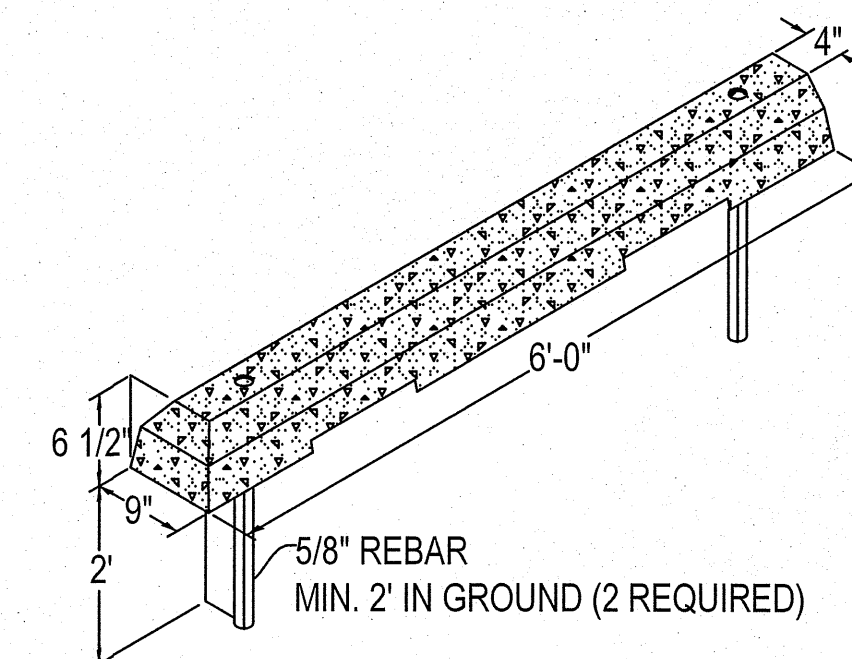

PRECAST CONCRETE WHEEL STOP
SCALE: NOT TO SCALE

THIS DRAWING IS THE PROPERTY OF ARENDELL ENGINEERS AND IS NOT TO BE REPRODUCED OR USED FOR ANY PROJECT IN WHOLE OR IN PART WITHOUT EXPRESS WRITTEN PERMISSION.

PROJECT MANAGER: JJW
DESIGNED: JJW
DRAWN BY: JST
CHECKED: JJW
SCALE: AS SHOWN
DATE: 01/27/2025

ARENDELL ENGINEERS
CIVIL - COASTAL - ENVIRONMENTAL
1004 Arendell Street
Morehead City, NC 28557
(252) 622-4338
Fax: (252) 622-4505

www.arendellengineers.com
North Carolina Certification No. C-1509
OWNER:

COLUMBUS COUNTY

PROJECT:
SHERIFF'S OFFICE
817 WASHINGTON STREET
WHITEVILLE, NORTH CAROLINA 28472

COLUMBUS COUNTY, NC

DRAWING:
DETAILS

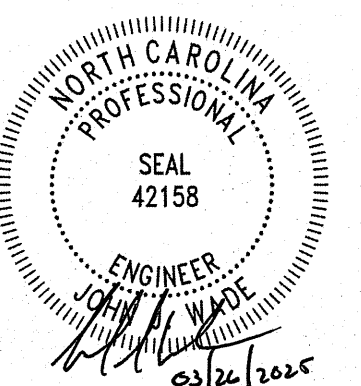

NO.	DATE	BY	REVISION	WATERLINE REVISIONS	PARKING AND DETAILS				
1	01/29/25	JJW							
2	03/26/25	JJW							

SHEET NO:

C8

OF: 8
JOB NO. 24265